

**GB Amalgam separator
ECONOMY SYSTEM TYPE 2**

Installation, operation and maintenance



Table of contents, Clarification of the pictograms

Groups of persons, to whom the concerned activities refer to, are mentioned on the last line.

1. Table of contents:

| | Page |
|---------------------------------------|------|
| 1. Table of contents | 2 |
| 2. Clarification of the pictograms | 2 |
| 3. General instructions | 3 |
| 4. Application | 3 |
| 5. Structure | 3 |
| 6. Clarification of the factory plate | 4 |
| 7. Technical data | 4 |
| 8. Assembling variants | 5 |
| 9. Installation guidelines | 5 |
| 10. Tube connections | 5 |
| 11. Replacing device | 6 |
| 12. Care, cleaning and disinfection | 7 |

2. Clarification of the pictograms:



Signifies that neglecting this instruction may lead to personal injury, operational malfunctions or material damages to the device as well as to surrounding areas!



signifies that the machine operators or engineers are especially reminded about important information.

General instructions, Application and structure

3. General instructions:



PURE WATER DEVELOPMENT guarantees the safety, reliability and performance of the device only if the following instructions are followed:

- ▶ Only authorised experts should carry out installation, modifications or repairs.
- ▶ The device must be used exclusively in accordance with the Installation, Operation and Maintenance Instructions.
- ▶ Use only genuine and original parts when repairing or replacing.
- ▶ Amalgam sludge disposal confirmations must be preserved in accordance with the laws of the country.
- ▶ *PURE WATER DEVELOPMENT* will make available all documents if an authorised engineer asks for them, which would be of use to technically qualified persons while carrying out service and repair work on the parts of the device.
- ▶ *PURE WATER DEVELOPMENT* assumes no responsibility for damages arising from external effect (improper installation), using wrong information, improper use of device or unauthorised repairs.
- ▶ Duplication and distribution of this Operating Instruction requires the prior consent of *PURE WATER DEVELOPMENT*.

4. Application:

ECONOMY SYSTEM TYPE 2 (in short: ECO II) is an amalgam separator with the so called, "advanced sedimentation technology", which is connected to the central suction systems.

5. Structure:

ECONOMY SYSTEM TYPE 2 combines the amalgam separator and the collector tank in one.

This means that once the device is completely filled with amalgam sludge, the entire ECONOMY SYSTEM TYPE 2 is replaced.

Clarification of the factory plate, Technical data

6. Clarification of the factory plate:

1 See diagram

The factory plate is located directly on the front side of the amalgam separator.

1.1 Device designation

1.2 Serial number

1.3 Manufacturer's address

1.4 Distributor's address

1.5 Max suction volume

1.6 Max water through-flow quantity

7. Technical data

| | |
|----------------------------------|--|
| Low pressure range: | 50 mbar - 300 mbar |
| Rate of sedimentation: | >95% in accordance with ISO DIS 11143 |
| Collection volume: | 0,4 gallons (1,5 Litre) 4,5 pound (ca. 2kg) - 0,18 gallons (700ml) amalgam wastes |
| Max ambient temperature: | 158° Fahrenheit |
| Possible suction systems: | wet or dry operated |
| Max water through-flow quantity: | 0,53 gallons / min |
| Dimensions (H x B x D) | 13,8 x 8,7 x 8,7 inches (350 x 220 x 220 mm) |
| Replacement interval | Approx. 12 - 24 months |

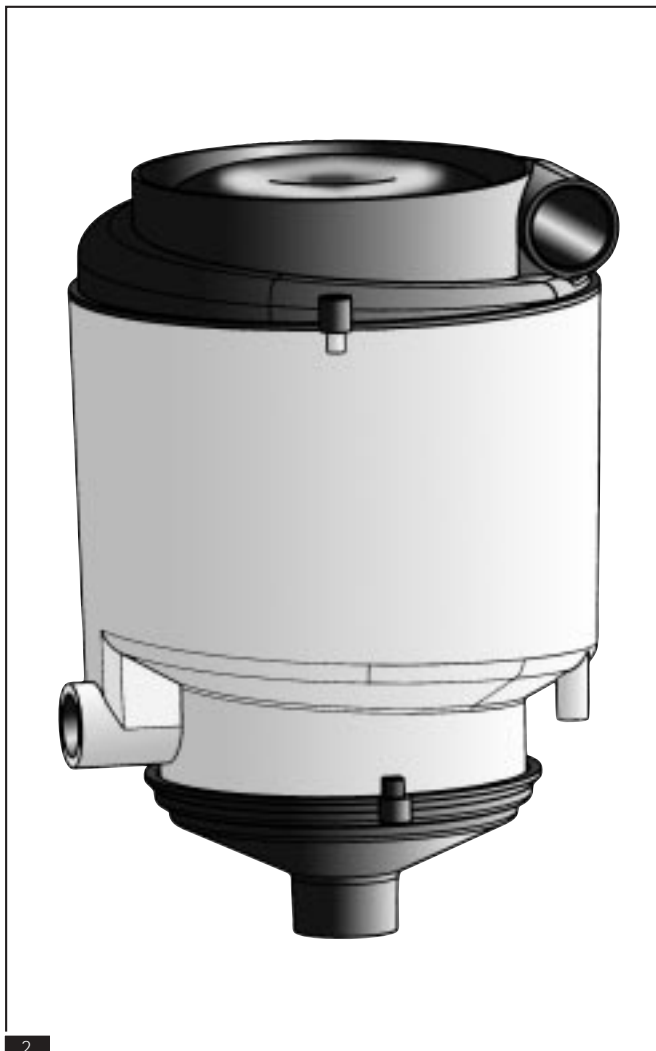
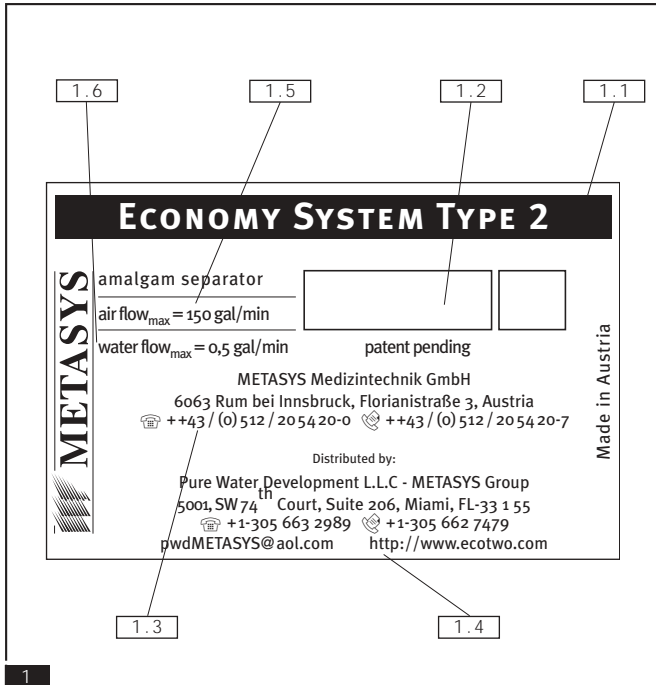

Assembling variants, installation guidelines

8. Assembling variants:

Various installation variants are available because the ECO-NOMY SYSTEM II is very easy to install.

3 Installing in front of the suction machine:

In case of wet suction machines, the device can be installed at any suitable place on the suction tube between the treatment unit and the suction machine.

4 Installing in the drain water tube:

If a wet operated suction machine is being used, the device is installed after the air – water separator 4.1 of the drain water tube.

5 Order variants:

If the separator is installed in the treatment room, there is a possibility of covering it with an elegant hood.

9. Installation guidelines

6 Montage:

At the time of the initial installation, both the bracket halves must be joined together with screws at places provided for the same 6.1.

7 Fixture:

Provide for free space with the following dimensions: H x B x D: 14.1 x 9 x 7.4 inches (360 x 230 x 190 mm)

The bracket, which is now ready, is fixed at a suitable place on the wall using appropriate screws 7.1. Care must be taken that the fixture element is positioned vertically above the level of the suction machine. Further it is also possible to mount the bracket on the floor.

Now, the device is placed on the guiding studs of the bracket.

7.2 See "Replacing the device", page 6/point 7-8

10. Tube connections

8 See diagram

8.1 Tube to the treatment unit

8.2 Tube to the suction motor

In order to guarantee a trouble free connection of different sizes of tubes, tube adapters supplied along with the device must be inserted in the inlet and outlet openings.

In any case ensure that all connections are properly secured!

◉ Filled level display:

The level of filling is displayed by optic control. When the amalgam sludge has reached its maximum filling level, contact your dental depot for replacement of the tank.



Even if the device is completely filled, you can continue to work without any problems. However, ECO II cannot give you a minimum separation output of 95% when it is full.

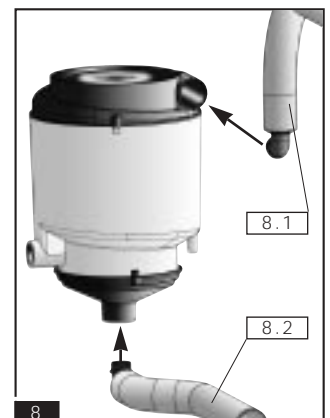
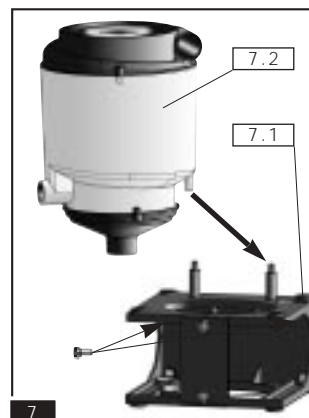
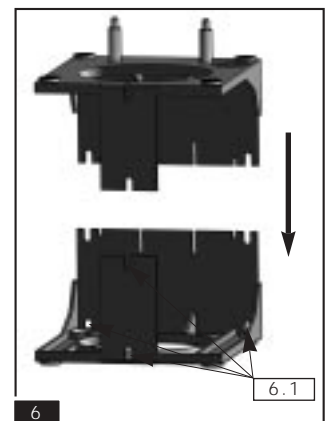
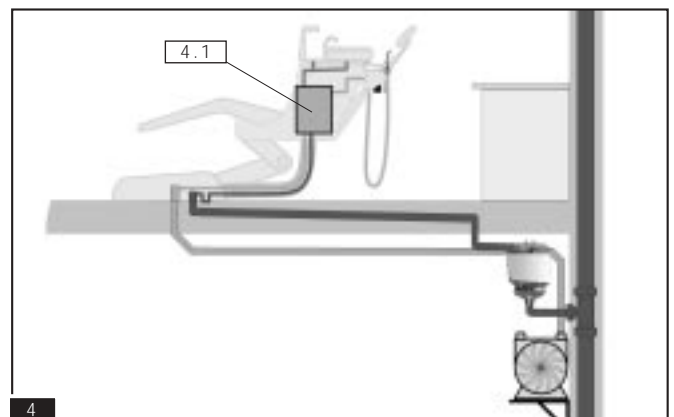
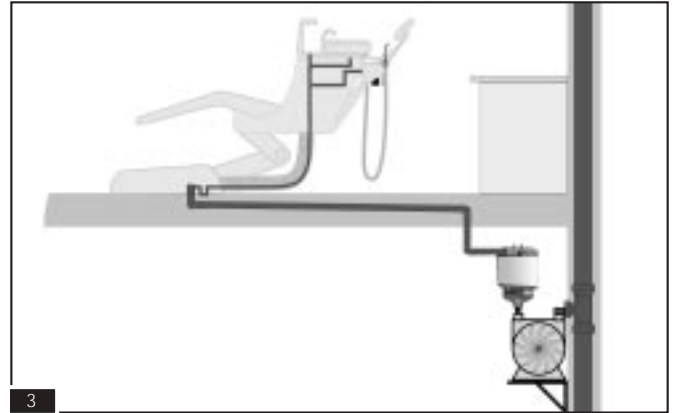

Replacing device

11. Replacing device:

As soon as the ECONOMY SYSTEM TYPE 2 has reached the maximum filling level, it is replaced by METASYS with a new ECO II.



It is not possible to open ECO II and reuse it! Trying to empty the device results in the required rate of separation not being achieved.

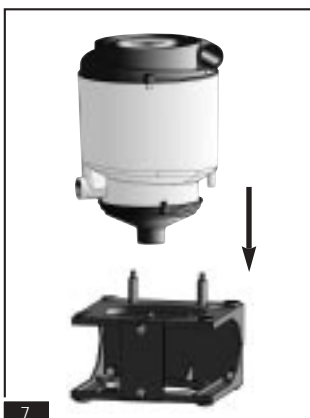
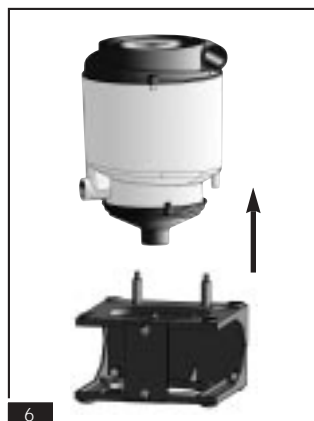

1 First remove the pipe at the inlet opening.

2 Pour the supplied disinfectant into the device through the inlet opening.

3 Now, close the inlet opening using the supplied sealing cap by pressing it till the end.

4 Likewise, remove the pipe at the outlet opening.

5 Likewise, close this opening using the supplied sealing cap. Once again, press the sealing cap till the end.

6 Take out the device from the bracket by pulling it upwards.

7 Now place the new device on the bracket and on its guiding studs.

8 Close the suction pipes at the openings marked as "IN" and "OUT" once again. Use the supplied tube adapter if necessary.

▶ Suck in a large quantity of water – more than 0.5 gallons (2 liters) - to check the system for leakages. If leakages are found, check the tube connections.

▶ As agreed, *PURE WATER DEVELOPMENT* will take care of the disposal.

Care and cleaning with Green & Clean M2

12. Care and cleaning with Green & Clean M2

9 See diagram:

Operate the saliva rinsing device for a short time after every treatment.



10 See diagram:

Suck some water from each tube after every treatment.

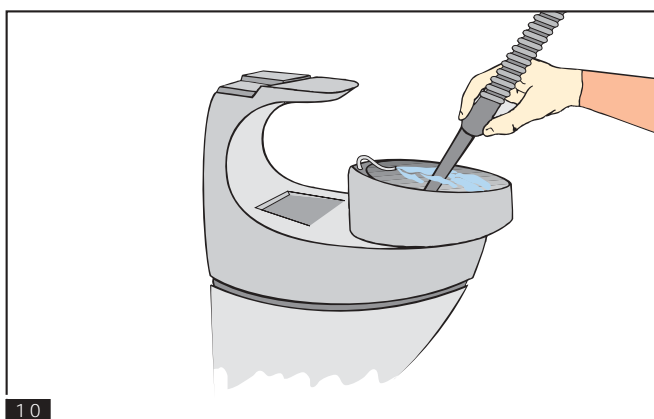

11 See diagram:

Due to reasons of material compatibility and to ensure smooth functioning of the device, use Green & Clean for care and cleaning of the amalgam separator.

Ideally, Green & Clean M2 should be used before long stand-still periods of the treatment unit (lunch break, closing for the day and vacation).

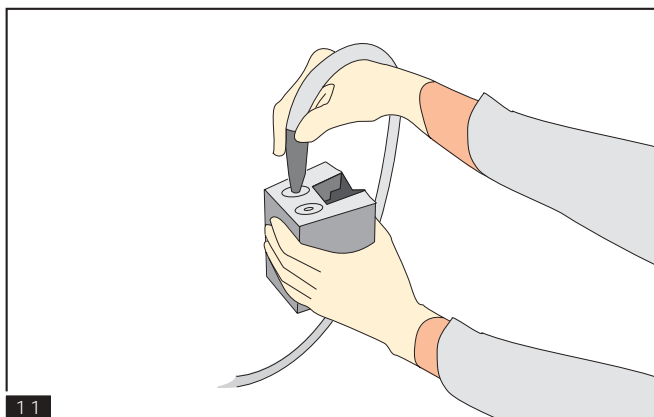

12 See diagram:

Likewise also rinse the saliva cup with Green & Clean M2 two times a day.

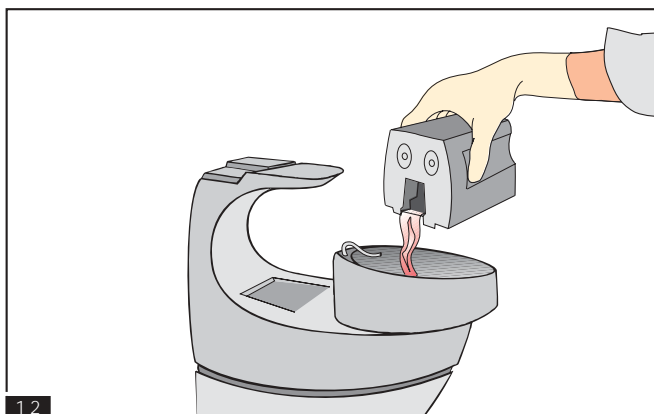



5001, SW 74th Court, Suite 206
Miami, FL-33 1 55
☎ +1-305 663 2989
☎ +1-305 662 7479
email: pwdMetasys@aol.com
<http://www.ecotwo.com>

Your Pure Water Development - agent: